

DEAD LOAD AND LIVE LOADS:

DEAD LOAD:

flooring	3.00 psf
conc o/ stl deck	35.00 psf
joists	
wt/ft	16.00 plf
	2.74 psf
ceiling	1.80 psf
structural elements	8.33 psf
misc	1.46 psf
Total Unit Weight	52.33 psf

TOTAL DEAD LOAD:

1,338,615 psf

LIVE LOAD:

RETAIL (LIGHT): 125 psf
Assembly (fixed seating): 60 psf

TOTAL LIVE LOAD:
2,002,377 psf

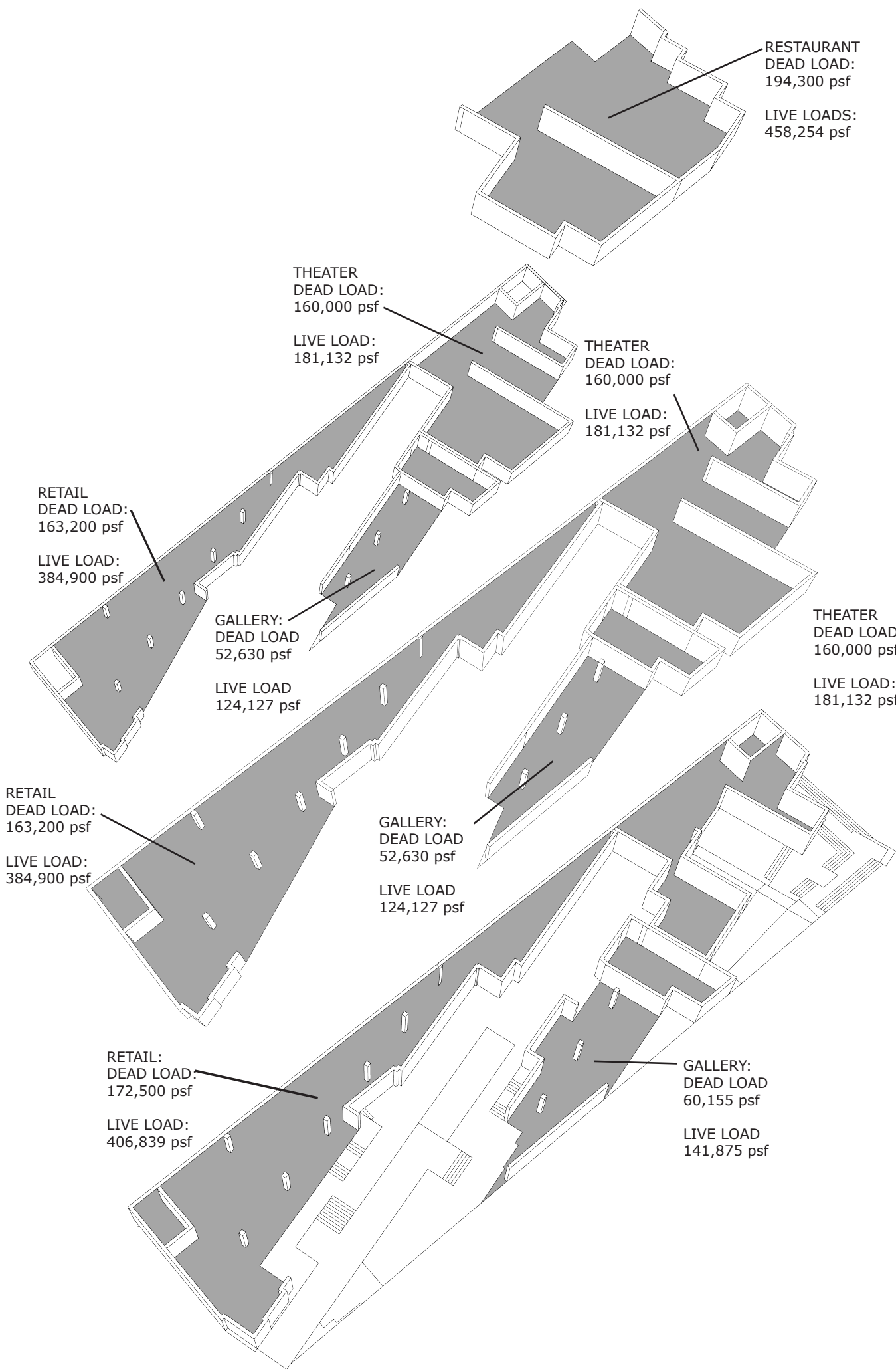

Project Name:
3500 STUDIO PROJECT

City, Country
Houston, Texas USA

Latitude/Longitude/Elevation
29°45'46"N 95°22'59"W
43ft

DAVID NORTHCUTT BROWN
0398907

ARCH 3427
TECHNOLOGY 3

DOSSIER ONE